

# UZV300-6

6V 300AH  
OPzV

# Ultracell®

Quality in Every Language

## UZV300-6

Awaiting Image

## Physical Specification

Part Number	UZV300-6
Length	145 ± 2 mm
Width	206 ± 2 mm
Container Height	355 ± 2 mm
Total Height (with terminal)	390 ± 2 mm
Approx Weight	26.0 kg

## Specifications

	Nominal Voltage	6V
	Nominal Capacity (20HR)	300.0AH
<b>Terminal Type</b>	Standard Terminal	F11
<b>Container Material</b>	Standard Option	ABS
	Flame Retardant Option (FR)	ABS (UL94:VO)
<b>Rated Capacity</b>	10hr, 1.80V/cell, 25°C	300 AH/30.0A
	5hr, 1.75V/cell, 25°C	263 A H/52.6A
	3hr, 1.75V/cell, 25°C	233.7 AH/77.9A
	1hr, 1.60V/cell, 25°C	171 AH/171A
<b>Max Discharge Current</b>	2400A (5s)	
<b>Internal Resistance</b>	Approx 1.0mΩ	
<b>Discharge Characteristics</b>	Operating Temp. Range	Discharge: -20 ~ 55°C
		Charge: 0 ~ 40°C
		Storage: -20 ~ 50°C
	Cycle Use	Initial Charging Current less than 75.0A. Voltage 2.40V ~ 2.50V Temp. Coefficient -5mV/°C
	Standby Use	No limit on Initial Charging Current Voltage 2.25V ~ 2.30V Temp. Coefficient -3mV/°C
Capacity affect by Temperature	40°C	103%
	25°C	100%
	0°C	86%
<b>Design Floating Life at 20°C</b>	20 Years	
<b>Self Discharge</b>	Ultracell batteries may be stored for up to 6 months at 25°C(77°F) and then a refresh charge is required. For higher temperatures the time interval will be shorter.	

## Dimensions

### F11 Terminal

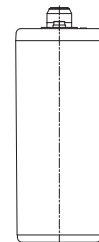
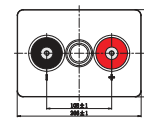
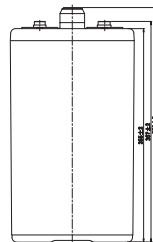
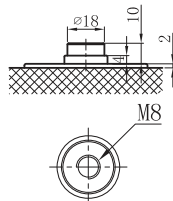

## Constant Current Discharge (Amperes) at 20°C

F.V/Time	10min	15min	30min	1h	2h	3h	5h	8h	10h
1.85V/cell	256	233	183	135	91.2	70.0	47.8	33.3	28.1
1.80V/cell	315	282	214	152	100	76.2	51.6	35.7	30.0
1.75V/cell	373	316	228	158	103	77.9	52.6	36.3	30.5
1.70V/cell	418	344	241	164	106	79.5	53.4	36.8	30.8
1.65V/cell	449	364	251	168	108	81.0	54.2	37.2	31.1
1.60V/cell	470	377	257	171	109	81.9	54.8	37.5	31.4

## Constant Power Discharge (Watts) at 20°C

F.V/Time	10min	15min	30min	1h	2h	3h	5h	8h	10h
1.85V/cell	476	438	350	260	177	137	94.1	66.1	55.9
1.80V/cell	576	522	404	291	194	148	101	70.6	59.6
1.75V/cell	669	577	426	301	198	151	103	71.7	60.4
1.70V/cell	738	620	447	311	202	153	104	72.4	61.0
1.65V/cell	778	645	460	317	205	155	105	73.1	61.5
1.60V/cell	799	658	467	321	207	157	106	73.5	61.9

### Discharge Characteristics

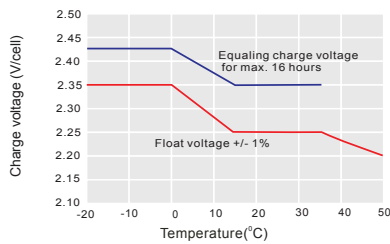

For continuous charging we recommend a voltage of 2.25 V. The charging voltage must be compensated to the curve for continuously different battery ambient temperature.

### Float Charging Characteristics

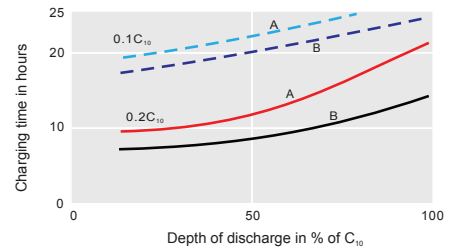

Charge voltage:  
A—2.25 V/cell      B—2.40 V/cell  
--- State of charge 100%      — State of charge 90%

### Temperature Effects in Relation to Battery Capacity

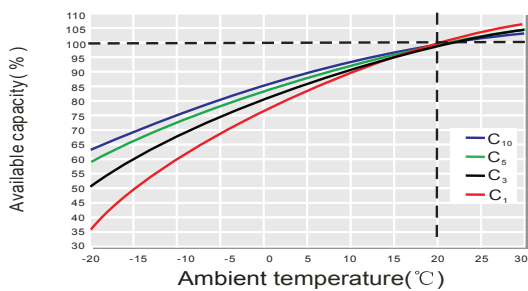

### Effect of Temperature on Long Term Float Life

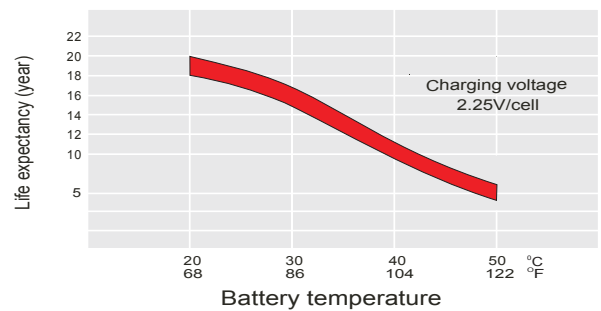

### Cycle Life in Relation to Depth of Discharge

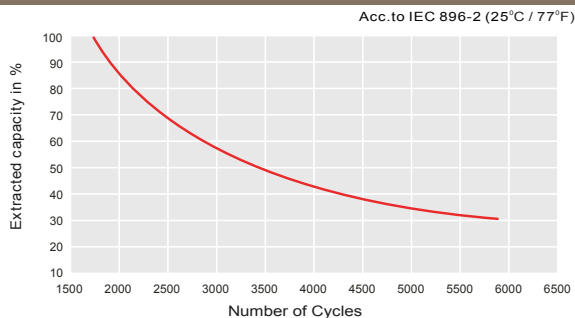

### General Relation of Capacity VS. Storage Time

